



شركة زهرة الواحة للتجارة  
Zahrat Al Waha for Trading Company



P.O Box 1339, Riyadh 11431  
Tel: +966 11 5458689 - Fax: +966 11 4781432  
Email: sm@zaoasis.com - yasser.alkhateeb@zaoasis.com  
hamdy.elfeki@zaoasis.com

**zaoasis.com**





**Specialized Expertise.  
Customized Success.**

## Vision

The company aims to become the best partner among the industrial and commercial companies in the field of plastic PET Preforms and HDPE closures throughout the GCC and the MENA region by increasing its activities, enhancing its existing relationship, building new relationships and gaining the confidence of its customers.

## Mission

Constructing a new concept in the plastic PET preforms and HDPE Closures sector by providing various products of different sizes and weights with the highest quality and services at competitive prices as well as meeting all the needs of its partners and customers.

The company seeks to capitalize on its leadership position to gain additional market share through expansion in the Kingdom and beyond (GCC and MENA region) by strengthening its position as a preferred partner for water and juice producers and achieving the company's vision.



# Introduction

It takes a great pleasure to introduce our organization Zahrat Al Waha for Trading Est. The company is engaged in the production of PET Preform and CAP. The factory is commissioned with state of art machinery of international repute, also we boast of having one of the finest laboratories for quality checks.

Our Mission is best defined as a one point customer oriented total which is provided through concrete planning, development, manufacturing and marketing that deliver measurable customer benefits.

The primary objectives of Zahrat Al Waha are to response on time, adhering to delivery schedule for the products that it manufactures and markets.

The company markets its production throughout Africa, Gulf and the Mediterranean and we are becoming one of the leaders in the region for providing PET preform & CAP, through a wide range of distributors.





The background of the slide features a close-up, slightly blurred image of numerous yellow plastic bottle caps. The caps are arranged in a way that creates a sense of depth and repetition. Overlaid on the left side of the image is a dark blue, semi-transparent banner with a rounded right edge. To the right of the text on this banner is a stylized graphic element consisting of three overlapping, curved shapes in a lighter blue color, resembling a flower or a modern logo.

## Our Products List

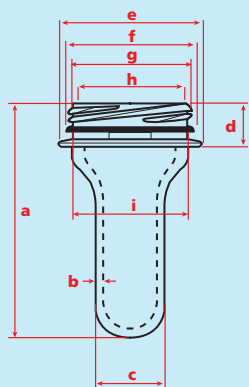

29/25 Short Neck

## PET Preforms 29/25 Short Neck

Item	Abbreviation	7.88 gram	8.3 gram	9 gram	9.4 gram	10.4 gram	11.4 gram	12.5 gram	13.5 gram	29.3 gram
Bottle size		200 ml	200 ml	200/330 ml	200/330 ml	330 ml	330 ml	500/600 ml	500/600 ml	1500 ml
Neck finish		29/25	29/25	29/25	29/25	29/25	29/25	29/25	29/25	29/25
Weight(gram)		7.8±0.20	8.3±0.20	9±0.20	9.4±0.20	10.4±0.20	11.4±0.20	12.48±0.20	13.5±0.20	29.3±0.30
Total Length(mm)	a	60.57±0.50	60.57±0.50	60.57±0.50	70.10±0.50	70.10±0.50	70.10±0.50	81.10±0.50	81.10±0.50	114.10±0.50
Wall thickness(mm)	b	1.60±0.19	1.83±0.15	2.23±0.15	1.81±0.15	2.20±0.15	2.63±0.15	2.14±0.15	2.45±0.15	2.93±0.15
Body diameter(mm)	c	16.31±0.10	16.31±0.10	16.31±0.10	16.40±0.10	16.4±0.10	16.40±0.10	18.17±0.10	18.17±0.10	25.54±0.10
Neck height(mm)	d	12.60±0.10	12.60±0.10	12.60±0.10	12.60±0.10	12.60±0.10	12.60±0.10	12.60±0.10	12.60±0.10	12.60±0.10
Neck support ring(mm)	e	32.5±0.20	32.5±0.20	32.5±0.20	32.5±0.20	32.5±0.20	32.5±0.20	32.5±0.20	32.5±0.20	32.5±0.20
Pilfer proof Diameter(mm)	f	30.5±0.20	30.5±0.20	30.5±0.20	30.5±0.20	30.5±0.20	30.5±0.20	30.5±0.20	30.5±0.20	30.5±0.20
Thread dia(mm)	g	29.40±0.13	29.40±0.13	29.40±0.13	29.40±0.13	29.40±0.13	29.40±0.13	29.40±0.13	29.40±0.13	29.40±0.13
Bore dia(mm)	h	25.10±0.10	25.10±0.10	25.10±0.10	25.10±0.10	25.10±0.10	25.10±0.10	25.10±0.10	25.10±0.10	25.10±0.10
Below NSR dia(mm)	i	28.00±0.15	28.00±0.15	28.00±0.15	28.00±0.15	28.00±0.15	28.00±0.15	28.00±0.15	28.00±0.15	28.00±0.15
Preform per Gaylord(pcs)		27,072	27,072	27,072	23,616	23,616	23,616	18,720	18,720	9,600
Gaylords per 40 HC FCL		44	44	44	44	44	44	44	44	44
Qty/40 HC FCL		1,191,168	1,191,168	1,191,168	1,039,104	1,039,104	1,039,104	823,680	823,680	422,400

## PET Preforms 30/25 High Neck

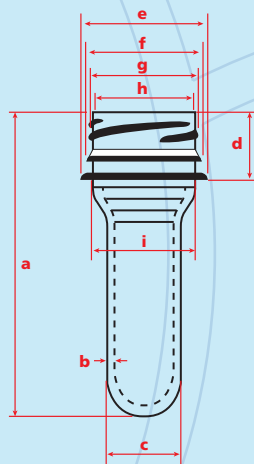

30/25 High Neck

Item	Abbreviation	9.04 gram	10.34 gram	11.3 gram	11.7 gram	12.7 gram	15.2 gram	16 gram	19 gram	21 gram	30.5 gram	32.5 gram
Bottle size		200 ml	200 ml	330 ml	330 ml	330 ml	500/600 ml	500/600 ml	500/600 ml	750 ml	1500 ml	1500 ml
Neck finish		30/25	30/25	30/25	30/25	30/25	30/25	30/25	30/25	30/25	30/25	30/25
Weight(gram)		9.04±0.20	10.34±0.20	11.3±0.20	11.7±0.20	12.7±0.20	15.2±0.20	16±0.20	19±0.20	21±0.30	30.5±0.40	32.5±0.40
Total Length(mm)	a	66.47±0.50	66.47±0.50	75.50±0.50	75.50±0.50	75.50±0.50	92.00±0.50	92.00±0.50	92.00±0.50	104.00±0.50	120.00±0.50	120.00±0.50
Wall thickness(mm)	b	1.60±0.15	2.23±0.15	2.00±0.15	2.14±0.15	2.56±0.15	2.20±0.15	2.34±0.15	3.15±0.15	2.59±0.15	2.93±0.15	3.20±0.15
Body diameter(mm)	c	16.31±0.10	16.31±0.10	17.20±0.10	17.20±0.10	17.20±0.10	19.50±0.10	19.50±0.10	19.50±0.10	21.73±0.10	25.54±0.10	25.54±0.10
Neck height(mm)	d	18.5±0.10	18.5±0.10	18.5±0.10	18.5±0.10	18.5±0.10	18.5±0.10	18.5±0.10	18.5±0.10	18.5±0.10	18.5±0.10	18.5±0.10
Neck support ring(mm)	e	34.00±0.20	34.00±0.20	34.00±0.20	34.00±0.20	34.00±0.20	34.00±0.20	34.00±0.20	34.00±0.20	34.00±0.20	34.00±0.20	34.00±0.20
Pilfer proof Diameter(mm)	f	30.2±0.15	30.2±0.15	30.2±0.15	30.2±0.15	30.2±0.15	30.2±0.15	30.2±0.15	30.2±0.15	30.2±0.15	30.2±0.15	30.2±0.15
Thread dia(mm)	g	30.00±0.15	30.00±0.15	30.00±0.15	30.00±0.15	30.00±0.15	30.00±0.15	30.00±0.15	30.00±0.15	30.00±0.15	30.00±0.15	30.00±0.15
Bore dia(mm)	h	25.10±0.10	25.10±0.10	25.10±0.10	25.10±0.10	25.10±0.10	25.10±0.10	25.10±0.10	25.10±0.10	25.10±0.10	25.10±0.10	25.10±0.10
Below NSR dia(mm)	i	28.00±0.15	28.00±0.15	28.00±0.15	28.00±0.15	28.00±0.15	28.00±0.15	28.00±0.15	28.00±0.15	28.00±0.15	28.00±0.15	28.00±0.15
Preform per Gaylord(pcs)		22,176	22,176	20,160	20,160	20,160	14,880	14,880	14,880	14,000	8,640	8,640
Gaylords per 40 HC FCL		44	44	44	44	44	44	44	44	44	44	44
Qty/40 HC FCL		975,744	975,744	887,040	887,040	887,040	654,720	654,720	654,720	616,000	380,160	380,160



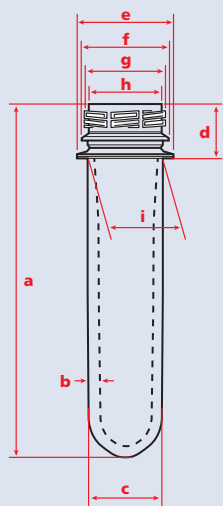

1881 PCO Short Neck

## PET Preforms 28mm PCO 1881 Neck Finish

Item	Abbreviation	16 gram	17.6 gram	22 gram	32.5 gram	50.06 gram
Bottle size						
Neck finish		1881 PCO	1881 PCO	1881 PCO	1881 PCO	1881 PCO
Weight(gram)	a	16±0.20	17.6±0.20	22±0.30	32.5±0.30	50.03±0.50
Total Length(mm)	b	85.37±0.50	85.37±0.50	90.80±0.50	110.82±0.50	149.80±0.50
Wall thickness(mm)	c	2.48±0.15	2.95±0.15	3.7±0.15	3.71±0.15	3.64±0.15
Body diameter(mm)	d	19.5±0.10	19.5±0.10	20.4±0.10	24.84±0.10	27.91±0.10
Neck height(mm)	e	17±0.20	17±0.20	17±0.20	17±0.20	17±0.20
Neck support ring(mm)	f	33.00±0.20	33.00±0.20	33.00±0.20	33.00±0.20	33.00±0.20
Pilfer proof Diameter(mm)	g	28.00±0.20	28.00±0.20	28.00±0.20	28.00±0.20	28.00±0.20
Thread dia(mm)	h	27.43±0.13	27.43±0.13	27.43±0.13	27.43±0.13	27.43±0.13
Bore dia(mm)	i	21.74±0.13	21.74±0.13	21.74±0.13	21.74±0.13	21.74±0.13
Below NSR dia(mm)		25.70±0.15	25.70±0.15	25.70±0.15	25.70±0.15	25.50±0.15
Preform per Gaylord(pcs)		16,512	16,512	16,512	10,560	6,336
Gaylords per 40 HC FCL		44	44	44	44	44
Qty/40 HC FCL		726,528	726,528	726,528	464,640	278,784

30/25 Twist-off Closure

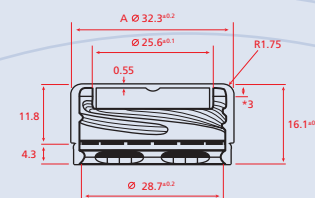

29/25 Twist-off Closure

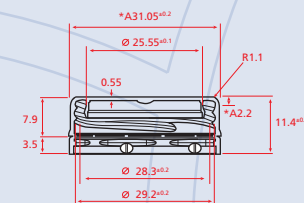

## CLOSURES

30/25 high neck - 29/25 short neck - 28 PCO 1881

Closure Type	29/25 short neck	30/25 High neck	28 PCO 1881
Weight(gram)	1.22±0.05	1.8±0.05	
Total Height(mm)	11.4±0.20	16.1±0.30	
Number of knurls	72	90	
Caps per carton	7000	5500	

# Quality Control

Zahrat Al Waha for plastic implements its Quality Management System which complies with the International quality management system standard ISO9001:2015 requirements, Food Safety Management System ISO22000:2005 and all GMP requirements to assure the continual improvements for our products, processes and achieving our customers needs and satisfaction.

Our QC laboratory equipped with highest technology testing laboratories equipment to monitor and assure the quality of our raw material and finished products.

## Why Zahrat Al Waha should be your packaging partner?

- Highly skills /trained team is available in the plant 7/24.
- Using only the virgin resin from high quality suppliers such as SABIC.
- From the raw materials to the finished preforms and closures, all the stages of the production have been tested sensitively according to manufacturing/ customer standards.
- Using highest technology in infrastructure, injection machines and molds from the best manufacturers such as Husky, Corvaglia and Piovan.
- Zahrat Al Waha Plant is available when quality and quantity are needed.







[zaoasis.com](http://zaoasis.com)



شركة زهرة الواحة للتجارة  
Zahrat Al Waha for Trading Company

